



39 Granville Road, Gillingham, Kent, ME7 2PB

WE ARE FULLY BOOKED FOR THE OPEN DAY 16TH JULY ***IN NEED OF MODERNISING*** GREAT LOCATION ***5 MINUTE WALK TO STATION***

Period charm with the space to match, this mid terrace family house is a home of generous proportions although in need of a refurbishment, it is defined by its original character features, ideal location close to amenities, town centre and train station. There is a good size living area that leads onto the kitchen, lobby, bathroom and a lean-to. There is a double cellar which are both great sizes. To the first floor there are three double bedrooms.

Externally the rear garden has a paved area with a large lawn. Gas central heating. Council Tax Band B. Please note that Grant of Probate is awaited and this needs to be back before completion can take place.

- THREE BEDROOMS
- DOUBLE CELLAR
- CLOSE TO TOWN CENTRE
- 5 MIN WALK TO TRAIN STATION
- LARGE REAR GARDEN
- SPACIOUS LIVING AREA
- IN NEED OF MODERNISATION
- DOWN STAIRS BATHROOM
- COUNCIL TAX B

£200,000

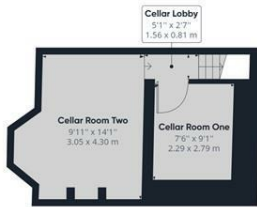

Floor -1 Building 1



Ground Floor Building 1



Floor 1 Building 1

Approximate total area⁽¹⁾
1044.74 ft²
97.06 m²

(1) Excluding balconies and terraces

While every attempt has been made to ensure accuracy, all measurements are approximate, not to scale. This floor plan is for illustrative purposes only.

GIRAFFE360

